

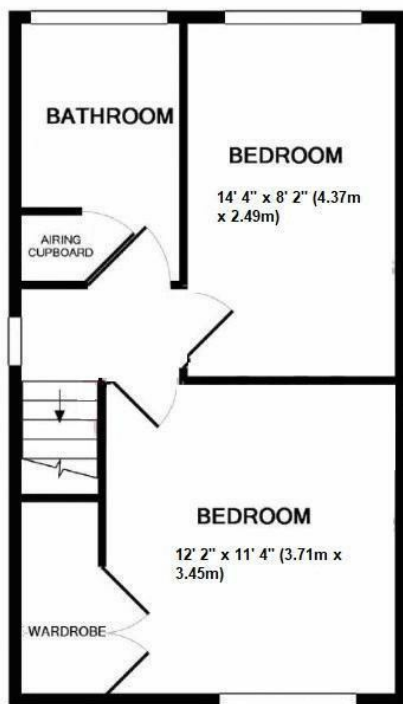

6 Rudman Park, Chippenham, Wiltshire, SN15 1NB

Asking Price £245,000

- Two Double Bedrooms
- Open Plan Lounge/Diner
- Enclosed Rear Garden with Gate Access to Allocated Parking Space
- Sought After Location
- Built in Wardrobe to Master Bedroom
- Freehold
- Close To Town Centre/Train Station
- Gas Central Heating/ Double Glazing



1ST FLOOR

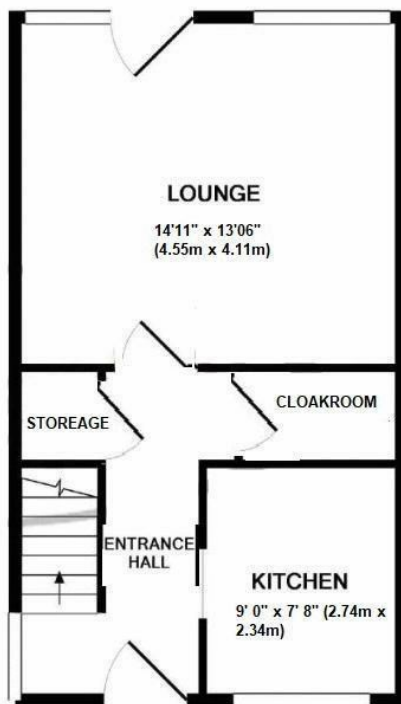

GROUND FLOOR



Directions

Viewings

Viewings by arrangement only. Call 01249 466999 to make an appointment.

Council Tax Band

B

EPC Rating:

Energy Efficiency Rating		
	Current	Potential
<i>Very energy efficient - lower running costs</i>		
(92 plus) A		
(81-91) B		
(69-80) C		
(55-68) D		
(39-54) E		
(21-38) F		
(1-20) G		
<i>Not energy efficient - higher running costs</i>		
England & Wales	EU Directive 2002/91/EC	